

Technical Support Notification

USM Module Update

► Overview

Veeder-Root has released a new version of the USM Module (332812-001) with additional noise filtering capabilities. The modifications were designed to specifically address DPLLD Comm Alarms at sites with Variable Speed Motors and include changes in internal hardware and firmware of the USM Module.

With the release of software version 9S, USM Modules manufactured before 2021 can upgrade their firmware to improve performance for installations that are exposed to high levels of electrical noise. All new USM Modules come with hardware improvements and the firmware pre-installed.

► Identifying the New Modules

All USM Modules manufactured in 2021 come pre-installed with the new hardware and firmware. There are two ways to identify these modules – the serial number or the build date.

All USM Modules with a **serial number of 549121010051 or higher** come pre-installed with the new hardware and firmware. The serial number can be found on the USM Module or in the diagnostics menu of the console. Modules with older serial numbers can upgrade the firmware only (*instructions on the next page*).



On the console go to **Menu → Diagnostics → Module → HW Configuration**

The USM Module serial number, hardware build date and firmware revision will be displayed.

The new firmware revision is 001-E.

Diagnostics > Module > HW Configuration					
Address	Module Type	Serial Number	Hardware Build Date	Firmware Revision	
B1.S1	UNIVERSAL SENS MODULE - 16	0021010422	01/25/2021	001-E	
B1.S2	INPUT/OUTPUT MODULE - 14	0019080089	08/08/2019	001-C	
B1.S3	INPUT/OUTPUT MODULE - 14	0019080090	08/08/2019	001-C	

Note: The first four digits (5491) of the serial number displayed on the sticker do not appear on the console. Scroll to the right to view the hardware build date and firmware revision.

All consoles manufactured in 2021 will ship out with the new USM Modules. The console serial number for all 2021 consoles starts with the letter "W". The serial number is located on a sticker on the bottom of the console.

► Instructions for Upgrading Firmware

Menu → Diagnostics → Module → Firmware

1. Check the box for the first USM module to be updated

Note: Only one USM can be selected at a time

2. Select **Actions** → **Install**

3. When ready, select the to continue

Address	Module Type	Serial Number	Current Firmware Revision
<input checked="" type="checkbox"/> B1.S1	UNIVERSAL SENS MODULE - 16	0019080216	001-C
<input type="checkbox"/> B1.S2	INPUT/OUTPUT MODULE - 14	0019080089	001-C
<input type="checkbox"/> B1.S3	INPUT/OUTPUT MODULE - 14	0019080090	001-C
<input type="checkbox"/> B1.S4	UNIVERSAL SENS MODULE - 16	0019080283	001-C

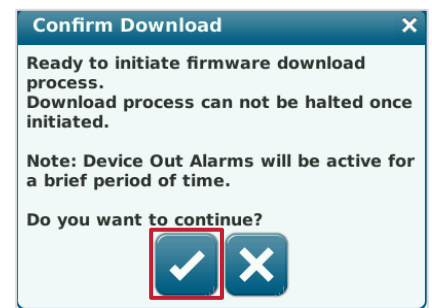
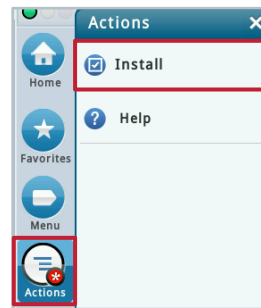

T 2: PROBE OUT 0 Warn 8 Alarm

#	Label	Alarm Description
<input type="checkbox"/> T 7	DEF	PROBE OUT
<input type="checkbox"/> T 6	Premium	PROBE OUT
<input type="checkbox"/> T 5	Diesel 2	PROBE OUT
<input type="checkbox"/> T 4	Diesel Primary	PROBE OUT
<input type="checkbox"/> T 3	Kerosine	PROBE OUT
<input type="checkbox"/> T 2	Secondary Unleaded	PROBE OUT
<input type="checkbox"/> TS 1	DEF Line	SENSOR OUT ALARM
<input type="checkbox"/> L 3	Dispenser 3	SENSOR OUT ALARM

Note: As shown on the **Confirm Download** screen, all programmed devices will go into open/out/comm alarms. These alarms will automatically clear after a few minutes.

4. The new firmware revision will be displayed: 001-E

Address	Module Type	Serial Number	Current Firmware Revision
B1.S1	UNIVERSAL SENS MODULE - 16	0019080216	<input checked="" type="checkbox"/> 001-E
B1.S2	INPUT/OUTPUT MODULE - 14	0019080089	001-C
B1.S3	INPUT/OUTPUT MODULE - 14	0019080090	001-C
B1.S4	UNIVERSAL SENS MODULE - 16	0019080283	<input checked="" type="checkbox"/> 001-E

► Further Information

- Contact Veeder-Root Technical Support at 1-800-323-1799 for additional help or questions.
- Learn more on our [TLS-450PLUS](https://www.veeder-root.com/tls-450plus) on our webpage.